

SCALE IN FEET

LEGEND

— Apx. Project Area

TITLE: SITE LOCATION
MAP

DATE: 11.15.2019

REVISION:

PROJECT NAME:
AIRPORT MAINTENANCE COMPLEX
123 MAIN STREET
EXAMPLE, IL 12345

CLIENT:
DEPARTMENT OF AVIATION
123 AIRPORT ROAD
EXAMPLE, IL 12345



DRAWN BY:
SCLARK

TNC PROJECT NO:
1234567

FIGURE
1

MAP DATA FROM: ESRI, NASA, NGA, USGS, FEMA / CITY OF CHICAGO, ESRI, HERE, GARMIN, INCREMENT P. METI/NASA. USGS. EPA. NPS. US CENSUS BUREAU, USDA

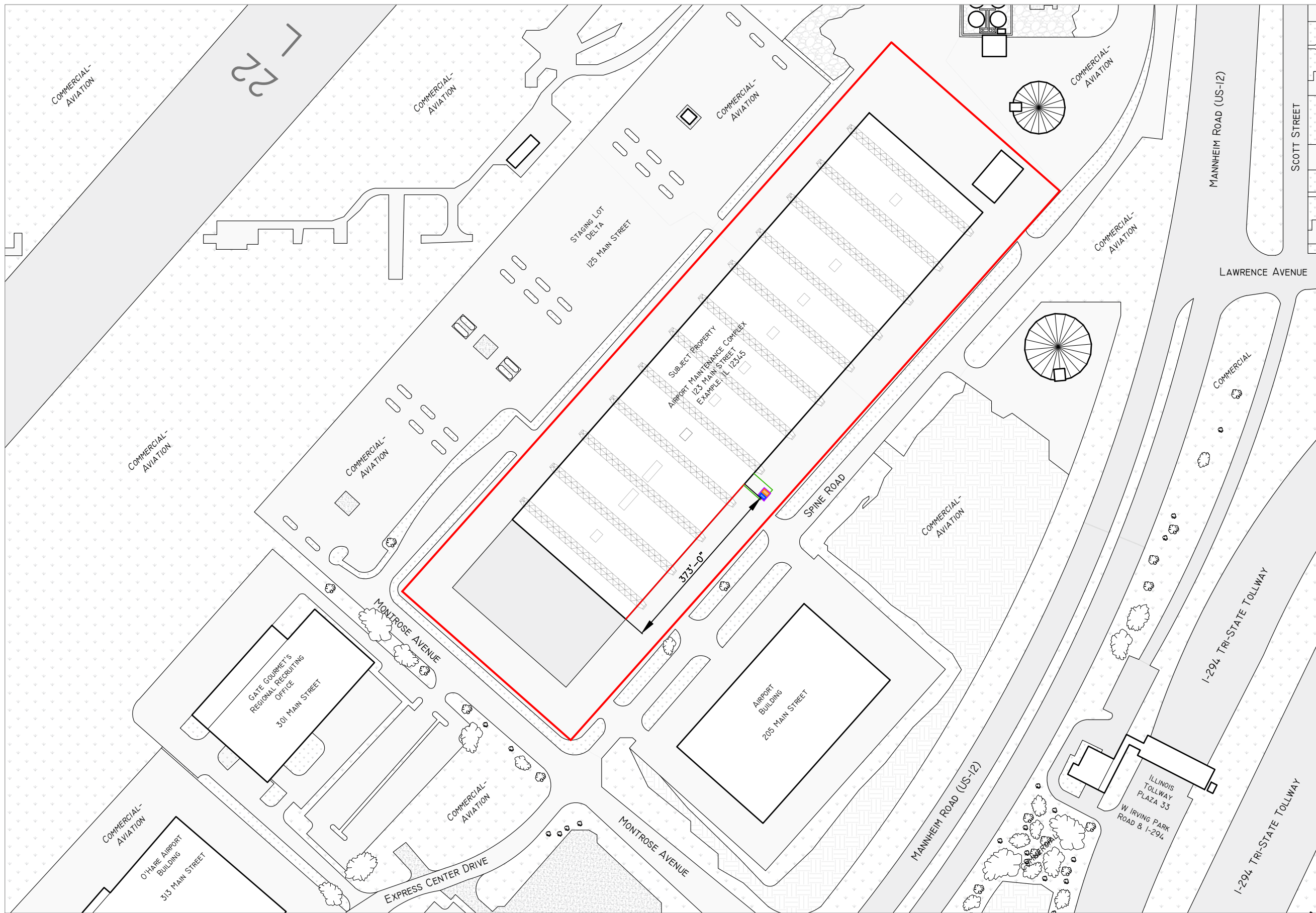

IMAGERY/SITE BOUNDARY DATA FROM: GOOGLE EARTH AND COOK COUNTY MAP APPLICATION

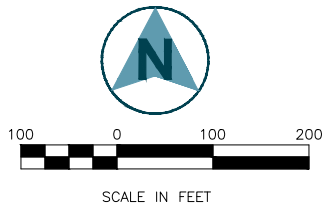

LEGEND

- Apx. Site Boundary
- Apx. Extent of UST Excavation
- Piping Trench
- Apx. Location of 4,000-Gallon Diesel UST - North
- Apx. Location of 2,500-Gallon Used Oil UST - South

TITLE: SITE & SURROUNDING LAND USE MAP

DATE: 11.15.2019

REVISION:

PROJECT NAME: AIRPORT MAINTENANCE COMPLEX
123 MAIN STREET
EXAMPLE, IL 12345

CLIENT: DEPARTMENT OF AVIATION
123 AIRPORT ROAD
EXAMPLE, IL 12345

EXAMPLE ENVIRONMENTAL

DRAWN BY: SCLARK

TNC PROJECT NO: 1234567

FIGURE 2

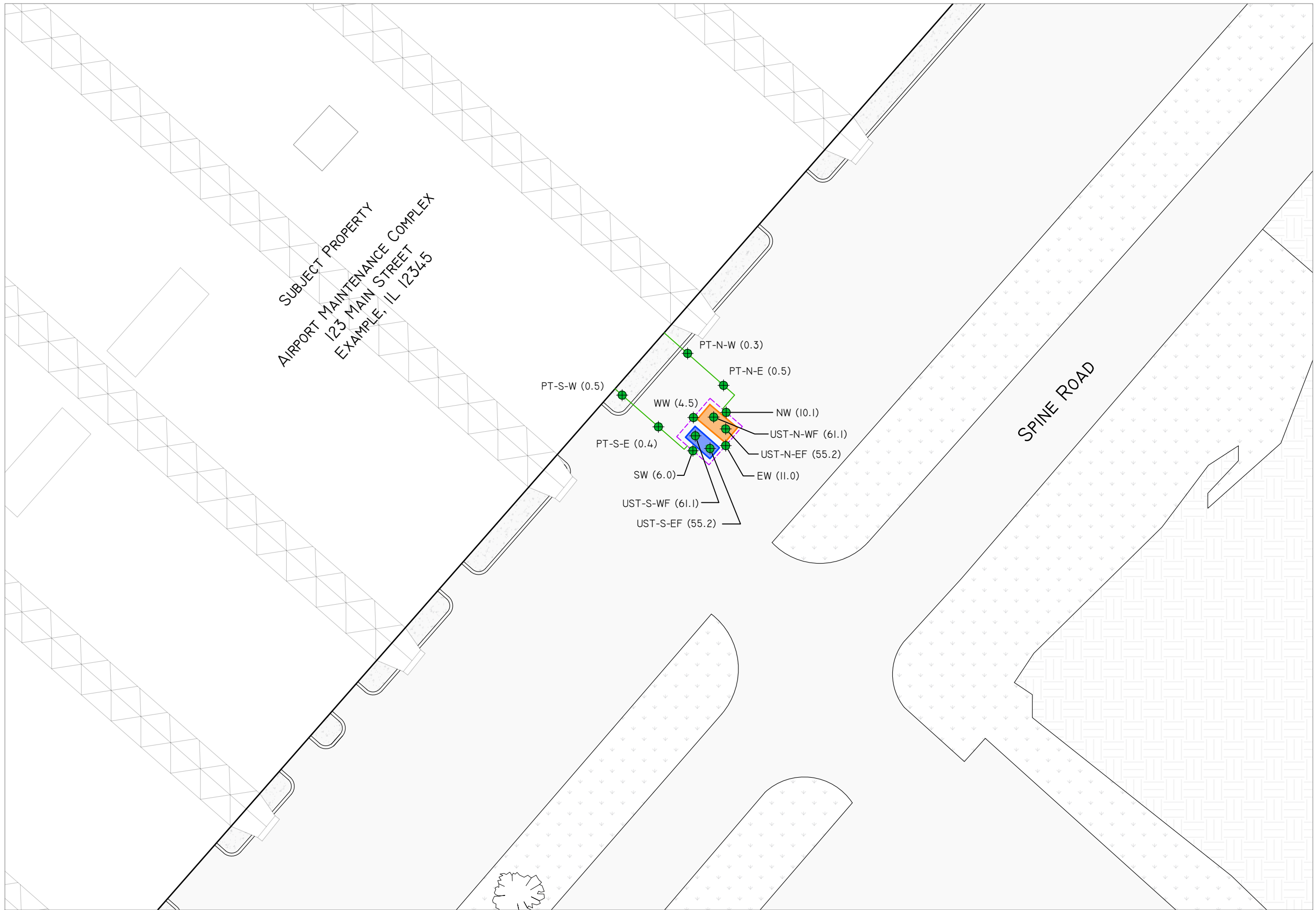

IMAGERY/SITE BOUNDARY DATA FROM: GOOGLE EARTH AND COOK COUNTY MAP APPLICATION

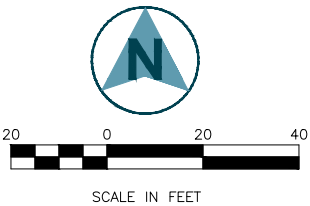

LEGEND

- Apx. Extent of UST Excavation
- Piping Trench
- Apx. Location of 4,000-Gallon Diesel UST - North
- Apx. Location of 2,500-Gallon Used Oil UST - South
- Sample Location (PID Reading - ppm)

NOTES:

No Utilities Observed in the Immediate Vicinity of the Excavation Area

TITLE:

SITE MAP

DATE:

11.15.2019

REVISION:

PROJECT NAME:

AIRPORT MAINTENANCE COMPLEX
123 MAIN STREET
EXAMPLE, IL 12345

CLIENT:

DEPARTMENT OF AVIATION
123 AIRPORT ROAD
EXAMPLE, IL 12345

EXAMPLE ENVIRONMENTAL

DRAWN BY:

SCLARK

TNC PROJECT NO:

1234567

FIGURE

3

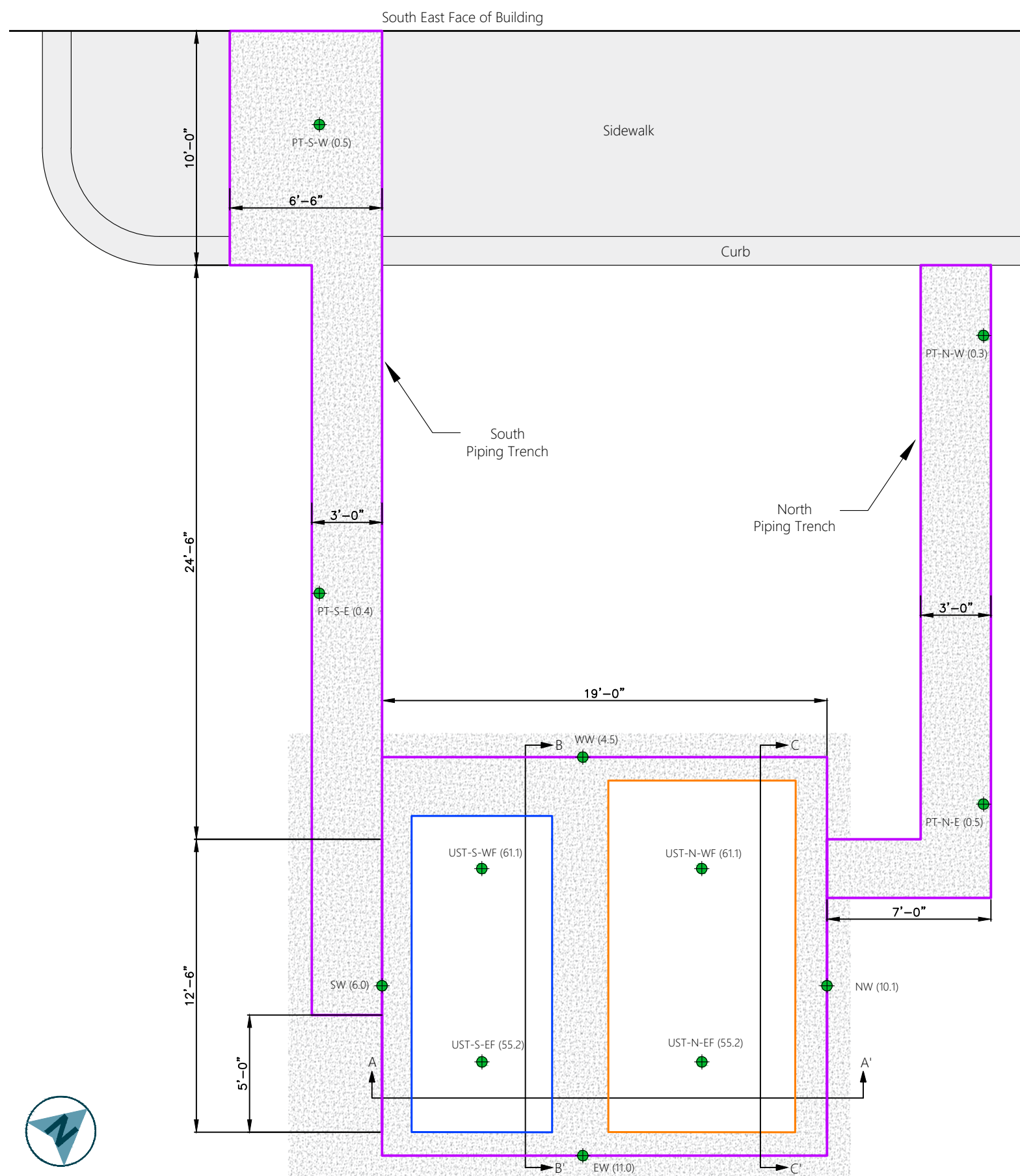

UST System Detail & Confirmation Soil Sampling Locations - Plan View

Scale: 3/16" = 1'-0"

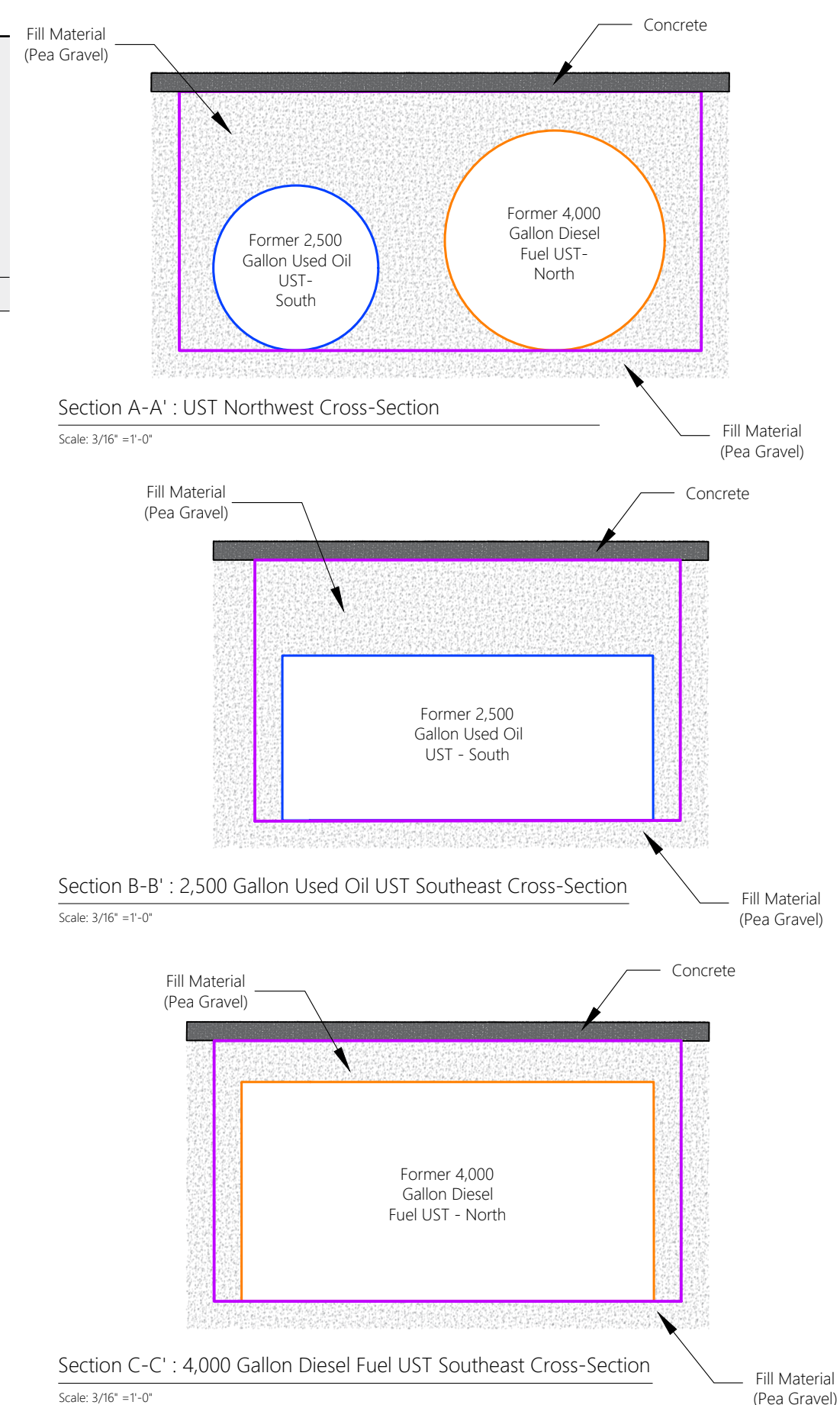

LEGEND

- Apx. UST Excavation Limits
- Apx. Location of 4,000-Gallon Diesel UST-North
- Apx. Location of 2,500-Gallon Used Oil UST-South
- Sample Location

SAMPLE NOTES:

PT-S-E (0.4) Sample Location/ID
PID Results in PPM

UST NOTES:

Former 2,500 Gallon UST
Dimensions:
162" (Length) x 72" ϕ (Nominal)

Former 4,000 Gallon UST
Dimensions:
180" (length) x 96" ϕ (Nominal)

SOUTH PIPING TRENCH NOTES:

The area underneath the Sidewalk was Excavated to Apx. 1.5' (Deep);
The trench East of the Sidewalk was Excavated to Apx. 2.0' (Deep)

NORTH PIPING TRENCH NOTES:

The western part of the Trench, Starting at the sidewalk and continuing for 5' East of the Sidewalk, was Excavated to Apx. 2.5' (Deep); From there continuing East 18' the Excavation changed to 3.75' (Deep); The balance of the trench 23' East of the Sidewalk up to the UST Excavation Area was Excavated 2.5' (Deep)

TITLE: UST
DETAIL MAP

DATE: 11.15.2019

REVISION:

PROJECT NAME:
AIRPORT MAINTENANCE COMPLEX
123 MAIN STREET
EXAMPLE, IL 12345

CLIENT:
DEPARTMENT OF AVIATION
123 AIRPORT ROAD
EXAMPLE, IL 12345

EXAMPLE ENVIRONMENTAL

DRAWN BY:
SCLARK
TNC PROJECT NO:
1234567

FIGURE
4