

The background of the image features a collage of architectural blueprints and technical drawings. A large, light-colored cylindrical object, possibly a rolled-up blueprint, is positioned diagonally across the center. The drawings include various lines, dimensions, and labels. A large, stylized logo 'A3E' is overlaid on the right side, with the '3' containing a downward-pointing arrow. Below the logo, the text 'ENVIRONMENTAL CONSULTANTS' is written in a smaller font. To the right of the logo, the phone number '(888) 405.1742' is displayed vertically.

A3E
ENVIRONMENTAL
CONSULTANTS (888) 405.1742

CERTIFICATIONS

Certified Professional Geologist - Illinois

SBA
SBA WOSB

Certified Disadvantaged Business Enterprise with:

IDOT
PACE
CTA
METRA
City of Chicago
Metropolitan Water Reclamation District

NAICS Codes

562910 Remediation Services

541620 Environmental Consulting Services

541690 Other Scientific & Technical Consulting Services

541990 All Other Professional, Scientific & Technical Services

PSC: F107, F108, F109, F110, F111, F115

CAGE: 7DQG4

SIC: 89990700, 87489905, 87449904, 49590302



SBA WOSB
Woman Owned Small Business



Illinois Department of Transportation



SARAH CLARK

CADD Specialist

Sarah@A3E.com

(630) 863-2044

Sarah Clark is an accomplished Computer Aided Drafting and Design Professional with 20 years of diverse drafting and management experience.

Sarah has a strong combination of design expertise, project management and a thorough knowledge of environmental drafting practices. She leads the A3 Environmental Consulting team through many fast paced, high pressure projects to deliver projects on time with quality that exceeds expectations.

She lives the A3E ethos by communicating clearly, completing projects efficiently and displaying an extreme level of precision.

In her spare time she feeds her passion for teaching as a professor of CADD for Vocational and Technical Training, AutoCAD, Inventor, SolidWorks, and Pro E at the city college.



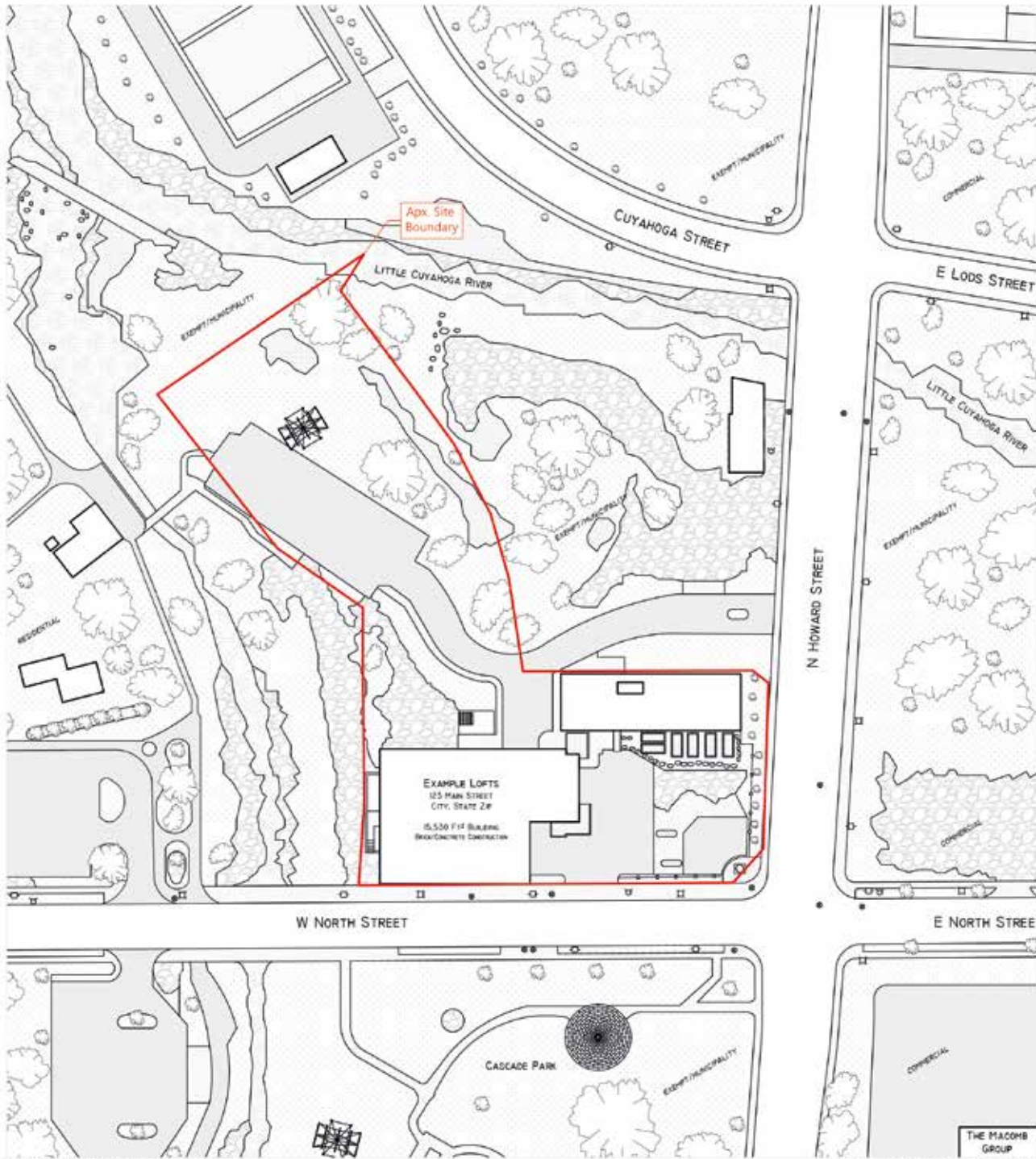

Site Information Adopted from
Parcel Viewer 2.0 and Google Earth

Locations and Dimensions are Approximate
Not a Legal Survey

Legend:

- Approx. Property Boundary
- Utility Pole
- Utility Pole with Light
- Fire Hydrant
- Manhole

<p>Title: Site Area Map</p>	 EXAMPLE ENVIRONMENTAL	<p>Project No: # 12345</p>	<p>Figure: 2</p>
<p>Project: Example Lofts 123 Main Street City, State Zip County</p>	<p>0 50 100 APPROXIMATE SCALE (IN FEET)</p>	<p>Date: 4.1.2019</p>	

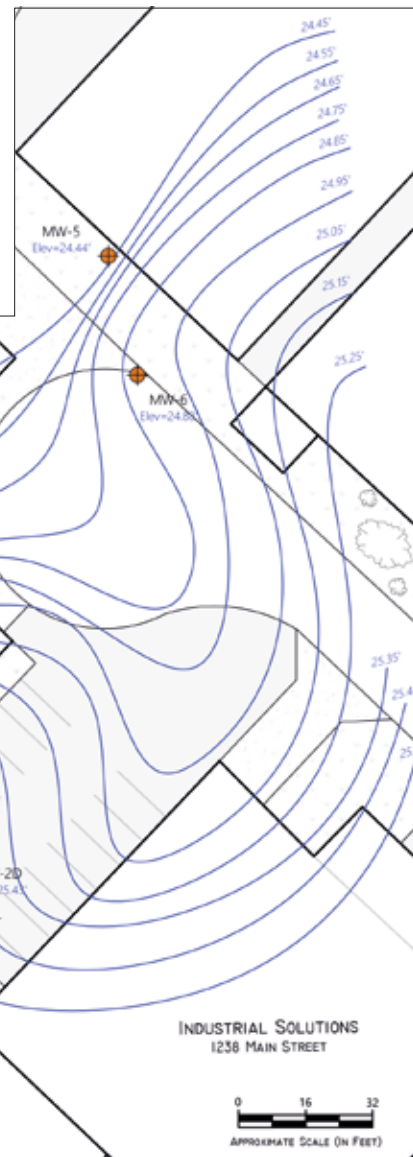
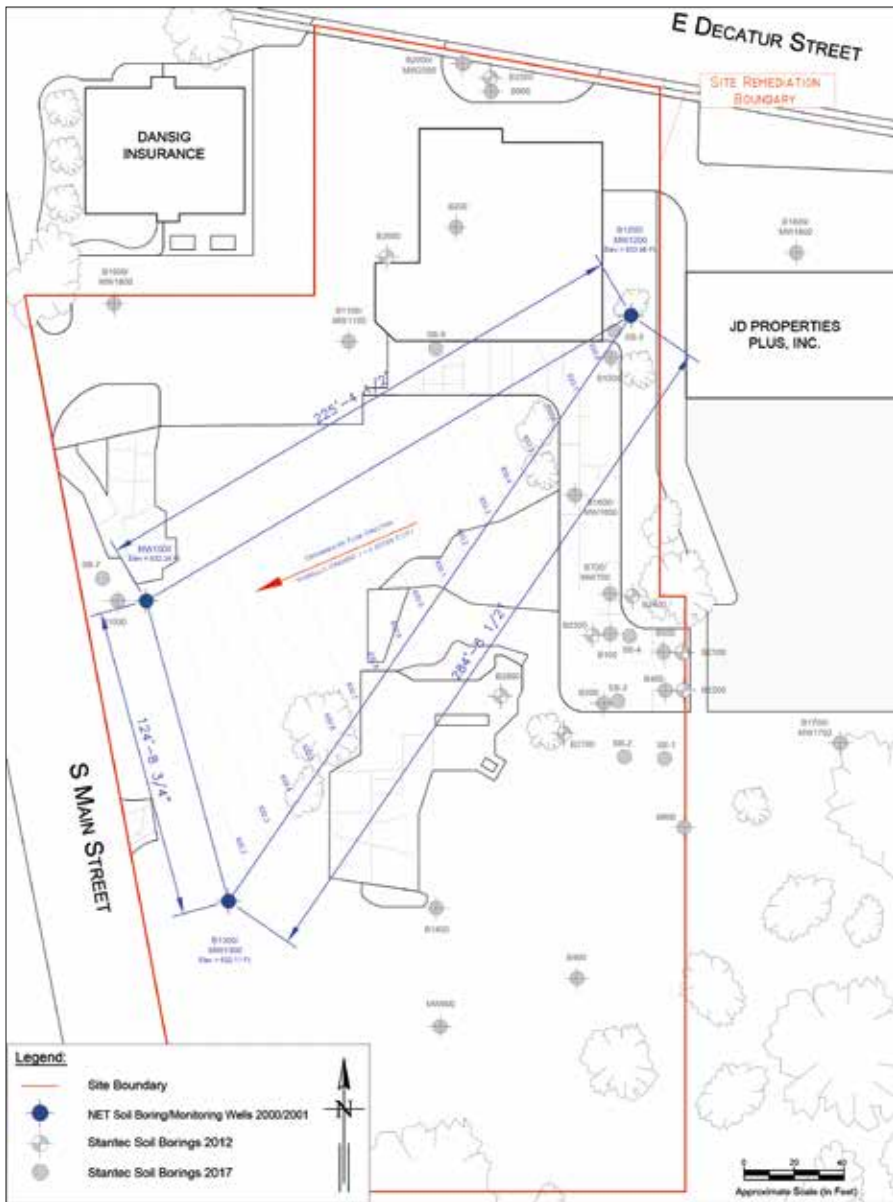

SITE BASE MAP
0325865423/KANE COUNTY
HAMPSHIRE/MIC'S DINER
SITE REMEDIATION PROGRAM/TECHNICAL REPORTS
12/8/2019

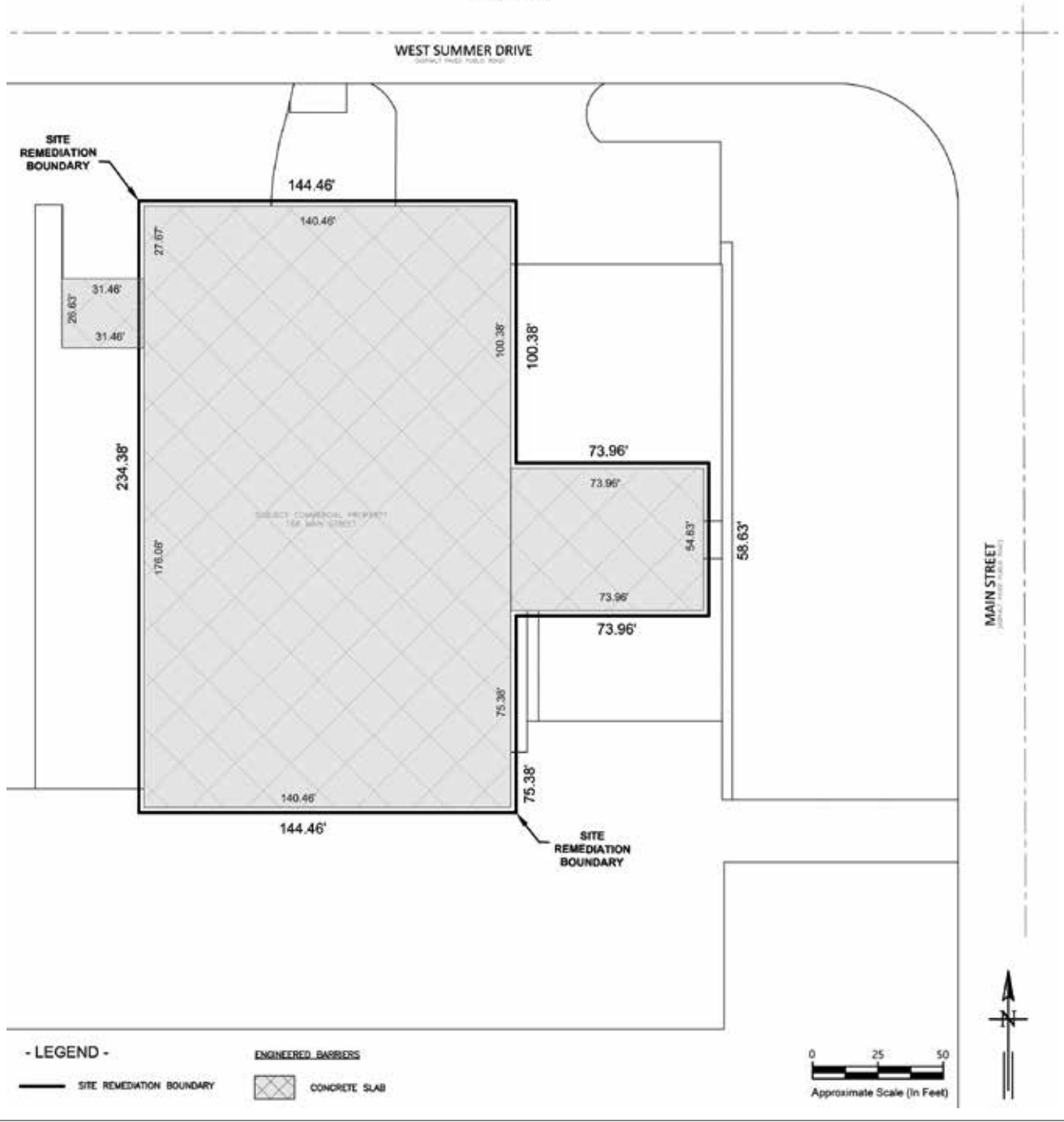

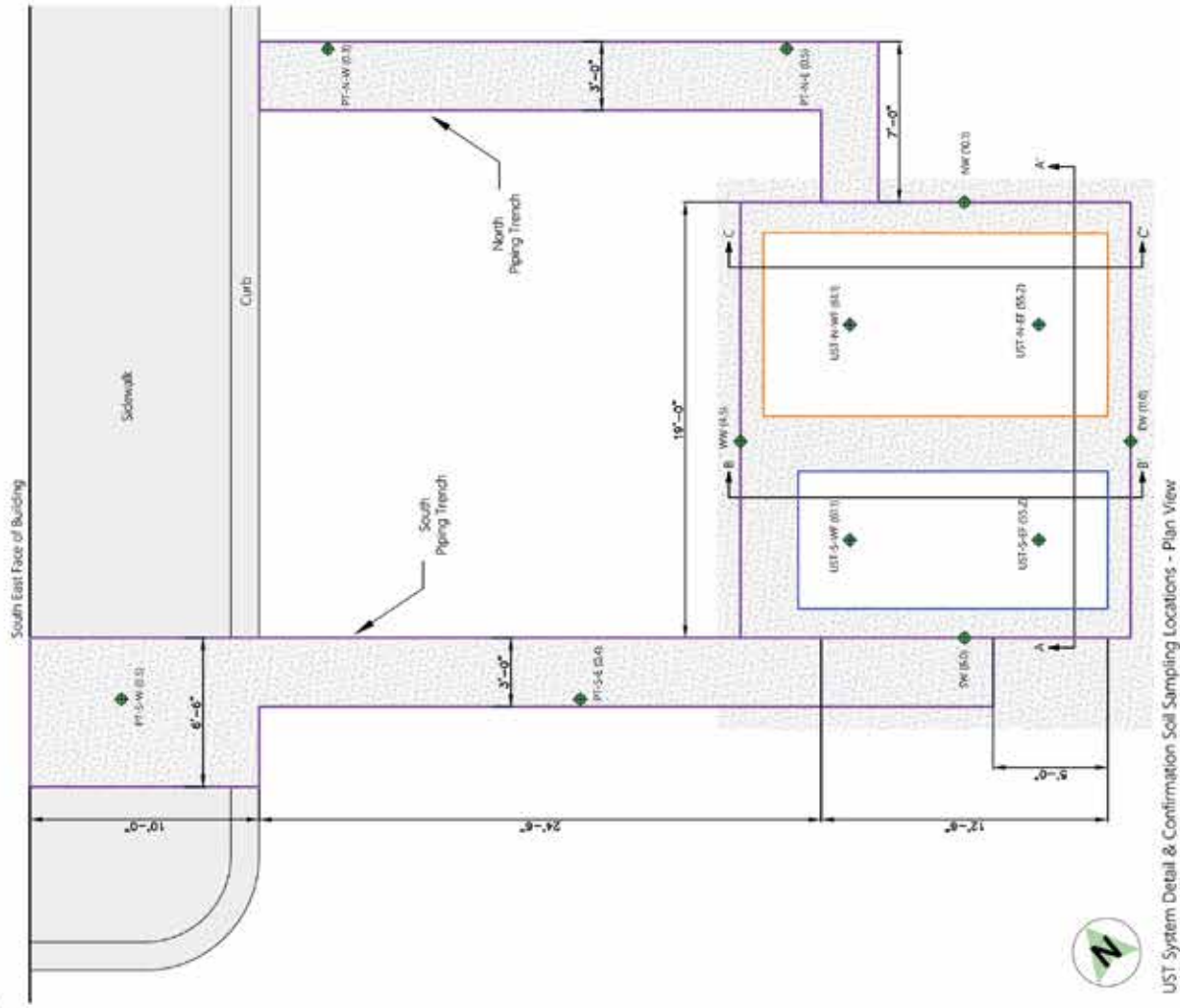

UST System Detail & Confirmation Soil Sampling Locations - Plan View
Scale: 3/8" = 1'-0"

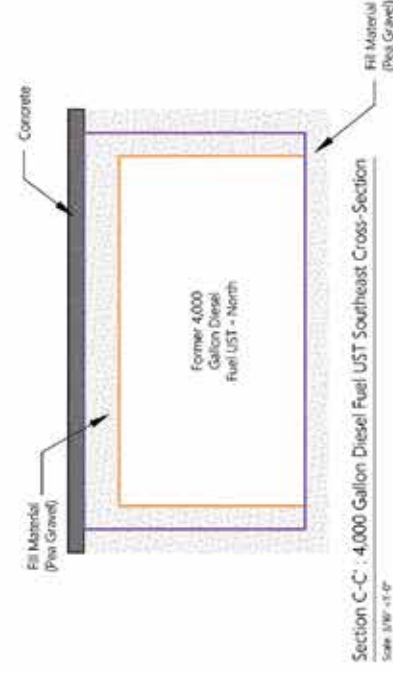
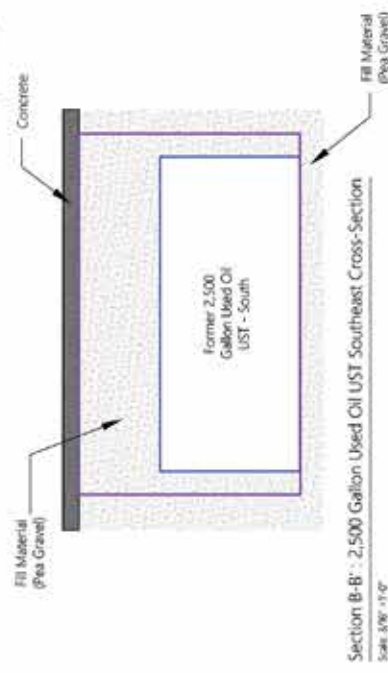
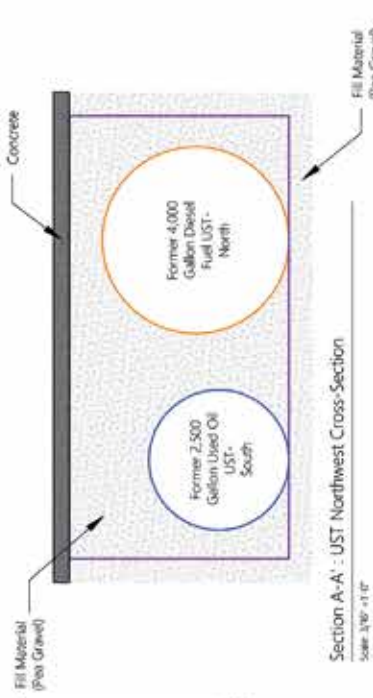

LEGEND

- Asst. UST Excavation Limits
- Asst. Location of 4,000 Gallon Diesel UST - North
- Asst. Location of 2,500 Gallon Used Oil UST - South
- Sample Location

SAMPLE NOTES

PT-S-W Sample Location/ID

PT-S-E Sample Location/ID

PT-N-W Sample Location/ID

PT-N-E Sample Location/ID

PT-S-W (0.3) Sample Location/ID

PT-S-E (0.3) Sample Location/ID

PT-N-W (0.3) Sample Location/ID

PT-N-E (0.3) Sample Location/ID

SW (0.3) Sample Location/ID

SE (0.3) Sample Location/ID

NE (0.3) Sample Location/ID

NW (0.3) Sample Location/ID

SW (0.3) Sample Location/ID

SE (0.3) Sample Location/ID

NE (0.3) Sample Location/ID

NW (0.3) Sample Location/ID

SW (0.3) Sample Location/ID

SE (0.3) Sample Location/ID

NE (0.3) Sample Location/ID

NW (0.3) Sample Location/ID

SW (0.3) Sample Location/ID

SE (0.3) Sample Location/ID

NE (0.3) Sample Location/ID

NW (0.3) Sample Location/ID

SW (0.3) Sample Location/ID

SE (0.3) Sample Location/ID

NE (0.3) Sample Location/ID

NW (0.3) Sample Location/ID

SW (0.3) Sample Location/ID

SE (0.3) Sample Location/ID

NE (0.3) Sample Location/ID

NW (0.3) Sample Location/ID

SW (0.3) Sample Location/ID

SE (0.3) Sample Location/ID

NE (0.3) Sample Location/ID

NW (0.3) Sample Location/ID

SW (0.3) Sample Location/ID

SE (0.3) Sample Location/ID

NE (0.3) Sample Location/ID

NW (0.3) Sample Location/ID

SW (0.3) Sample Location/ID

SE (0.3) Sample Location/ID

NE (0.3) Sample Location/ID

NW (0.3) Sample Location/ID

SW (0.3) Sample Location/ID

SE (0.3) Sample Location/ID

NE (0.3) Sample Location/ID

NW (0.3) Sample Location/ID

SW (0.3) Sample Location/ID

SE (0.3) Sample Location/ID

UST DETAIL MAP

DATE: 11.15.2019

REVISION:

PROJECT NAME:

PROJECT LOCATION:

PROJECT NUMBER:

PROJECT DATE:

PROJECT STATUS:

PROJECT DESCRIPTION:

PROJECT CONTACT:

PROJECT PHONE:

PROJECT FAX:

PROJECT EMAIL:

PROJECT WEBSITE:

PROJECT ADDRESS:

PROJECT CITY:

PROJECT STATE:

PROJECT ZIP:

PROJECT COUNTY:

PROJECT TOWN:

PROJECT WARD:

PROJECT DISTRICT:

PROJECT ZONE:

PROJECT SUBZONE:

PROJECT TRACT:

PROJECT LOT:

PROJECT UNIT:

PROJECT PHASE:

PROJECT SUBPHASE:

PROJECT SUBSUBPHASE:

FIGURE

4

GRAPHIC:

SCALE:

PROJECT NO:

DATE:

BY:

CHECKED:

APPROVED:

DATE:

BY:

CHECKED:

APPROVED:

DATE:

BY:

CHECKED:

APPROVED:

DATE:

BY:

CHECKED:

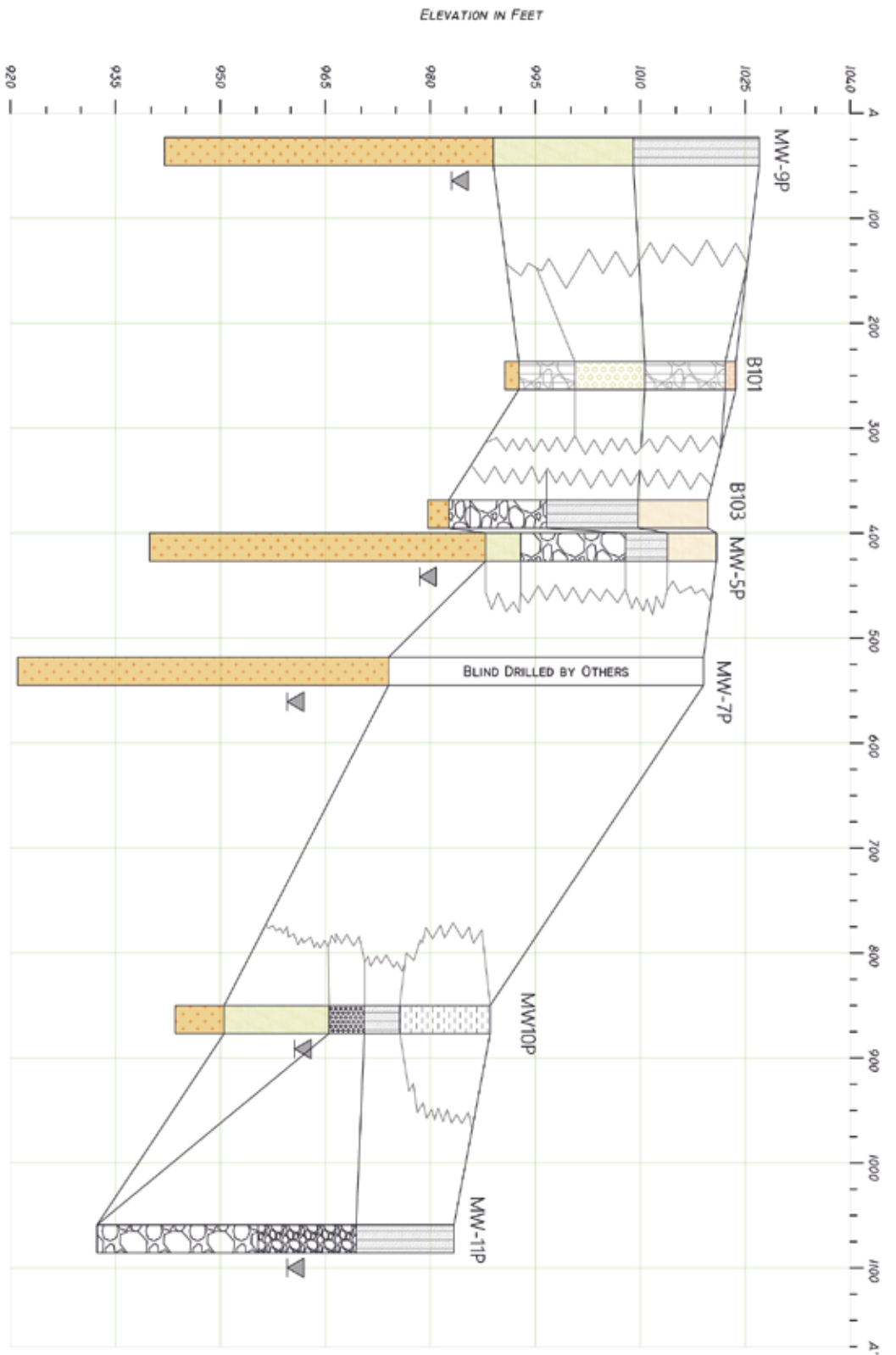

VERTICAL SCALE: 1" = 10'-0"
HORIZONTAL SCALE: 1" = 100'-0"

LEGEND

- Ground Surface
- GW - Well-grained granitic, gravel-sand medium, little or no fines
- GP - Poorly-grained granitic, gravel-sand medium, little or no fines
- GM - Silty granitic, gravel-sand medium
- SW - Well-grained sand, gravelly sand, little or no fines
- SP - Poorly-grained sand, gravelly sand, little or no fines
- SM - Silty sand, sand-silt medium
- CL - Organic clay and organic clay (clay of low plasticity)
- Sandstone
- Top Soil
- SP/FS - Poorly-grained sand, gravelly sand, little or no fines (thin-bedded)

TITLE

GEOTECHNICAL CROSS SECTION

DATE: 9.11.2019

REVISION:

PROJECT NAME:

10' COUNTY HWY A5

MADISON, WI 53701

CLIENT:

10' COUNTY HWY A5

10' COUNTY HWY A5

10' COUNTY HWY A5

10' COUNTY HWY A5

10' COUNTY HWY A5

10' COUNTY HWY A5

10' COUNTY HWY A5

10' COUNTY HWY A5

10' COUNTY HWY A5

10' COUNTY HWY A5

10' COUNTY HWY A5

10' COUNTY HWY A5

10' COUNTY HWY A5

10' COUNTY HWY A5

10' COUNTY HWY A5

10' COUNTY HWY A5

10' COUNTY HWY A5

10' COUNTY HWY A5

10' COUNTY HWY A5

10' COUNTY HWY A5

10' COUNTY HWY A5

10' COUNTY HWY A5

10' COUNTY HWY A5

10' COUNTY HWY A5

10' COUNTY HWY A5

10' COUNTY HWY A5

10' COUNTY HWY A5

10' COUNTY HWY A5

10' COUNTY HWY A5

10' COUNTY HWY A5

10' COUNTY HWY A5

10' COUNTY HWY A5

10' COUNTY HWY A5

10' COUNTY HWY A5

10' COUNTY HWY A5

10' COUNTY HWY A5



FIGURE 1

W25998

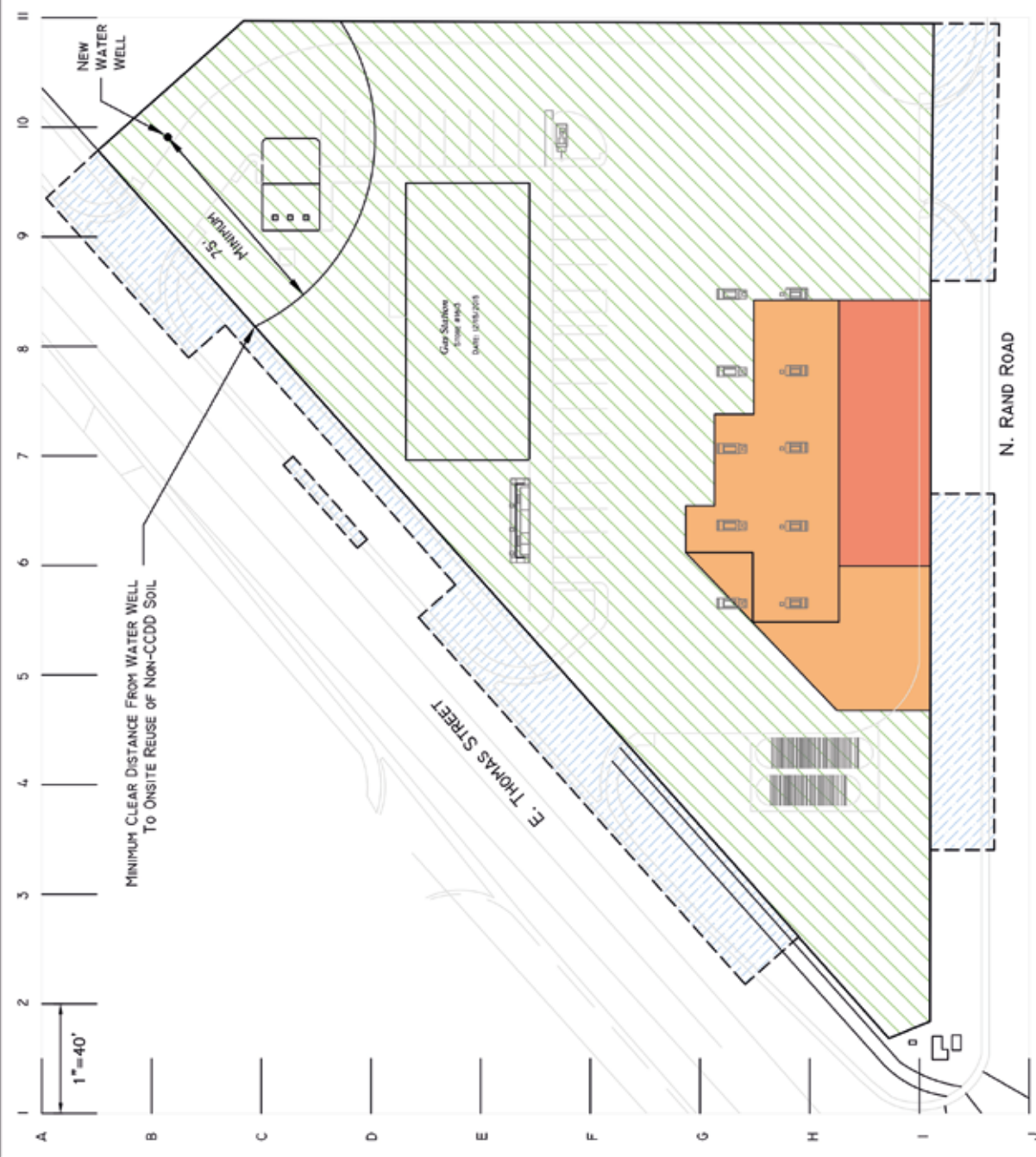

Legend:

Site Boundary

Project Limits

CCDD and Uncontaminated Soil
(No Reuse Restrictions)

Non-CCDD (Reuse Onsite)

Non-CCDD Within Row
(Subtitle D Landfill)

Soil Exceeding Taco Tier 1
(Subtitle D Landfill)

Title

Soil Management Plan

Project

**Example Gas Station
123 Main Street, City, State**

Drawn By:

SCC

Date:

3.21.2019

Figure

1



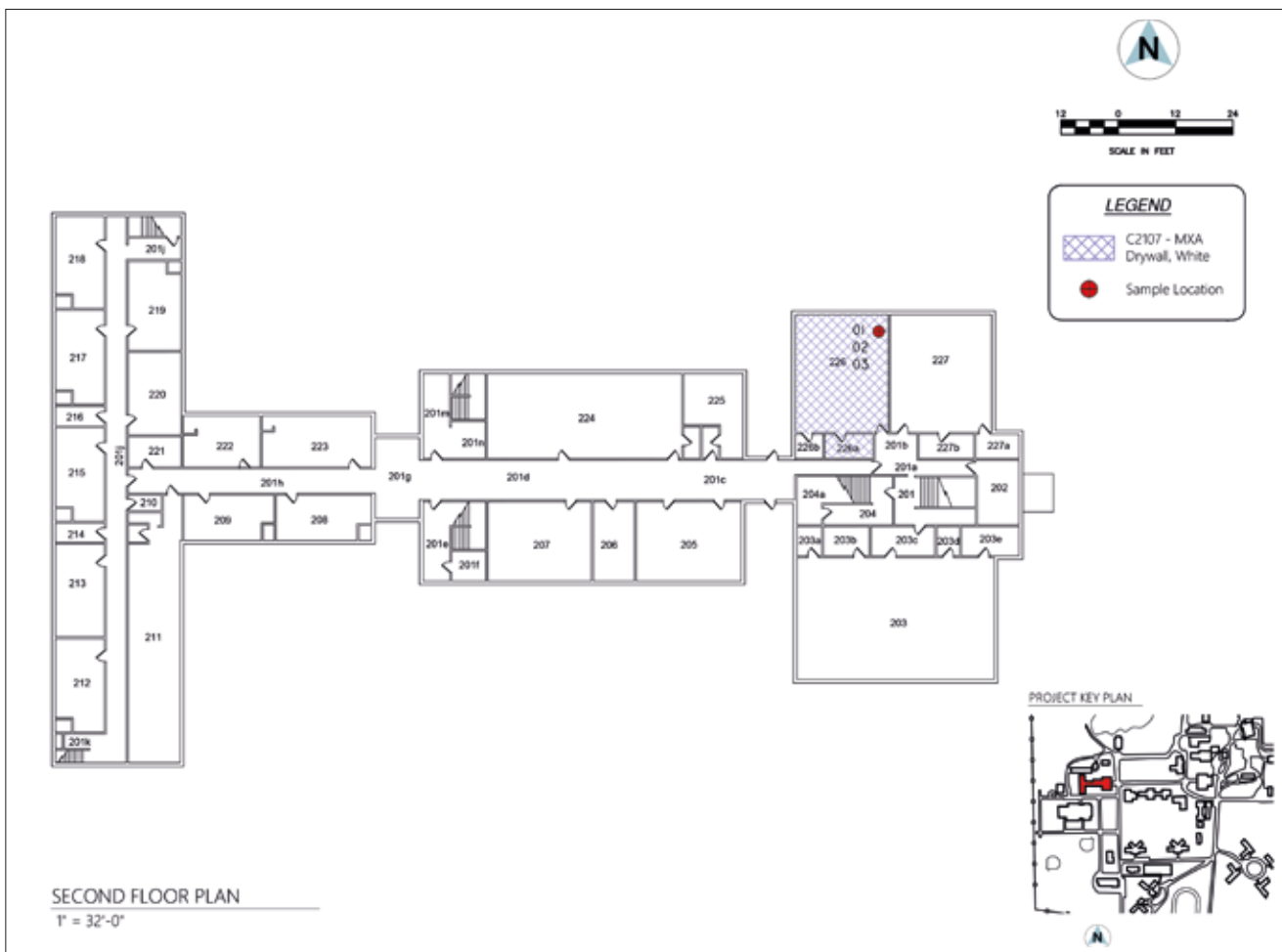
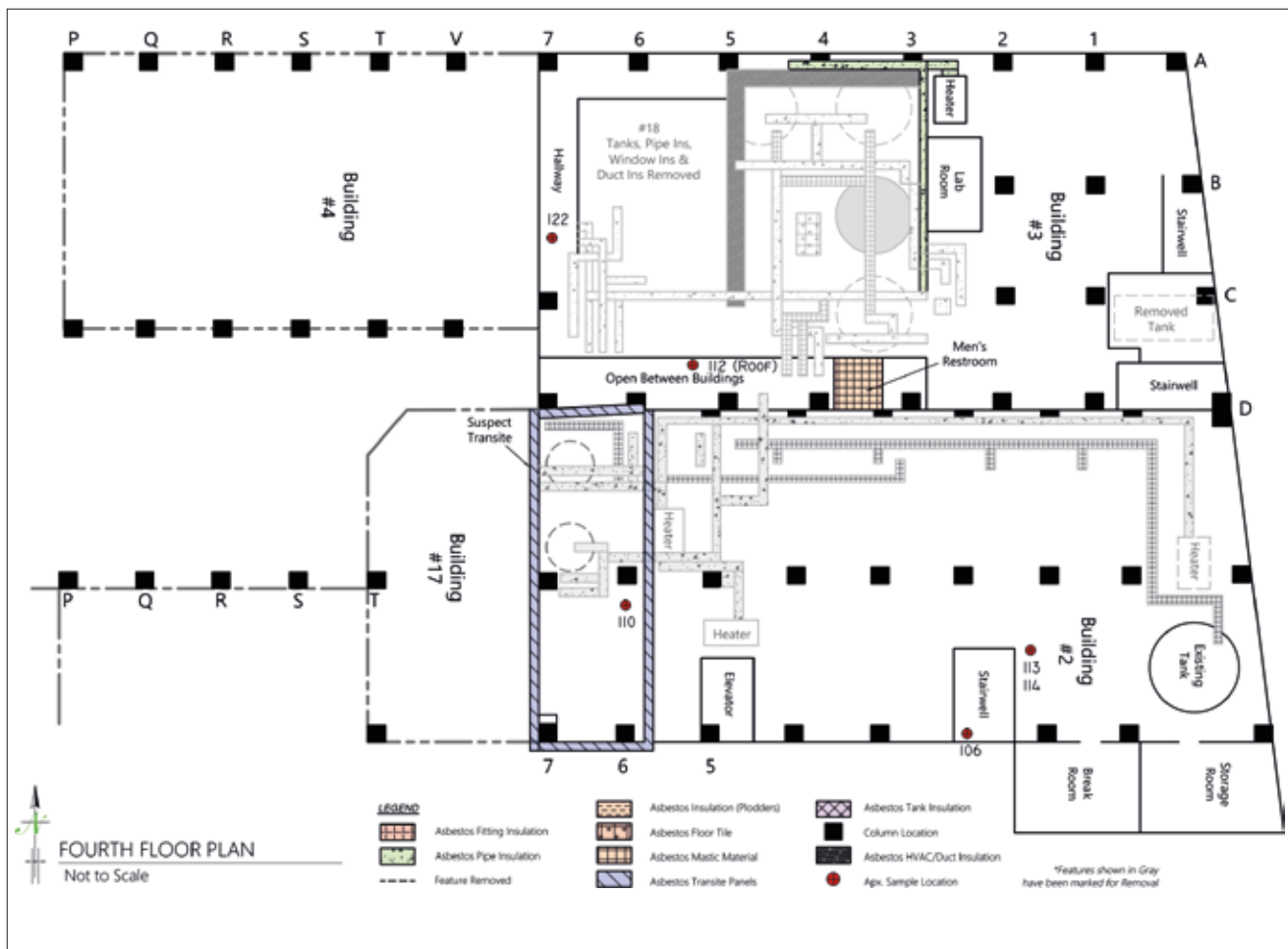



THE A3E TEAM CAN DESIGN ENVIRONMENTAL FIGURES FOR:

Phase I and II Environmental Site Assessments

SRP Site Closures

State Compliant Site Base Maps

Baseline Environmental Assessments

Groundwater Flow with Hydraulic Gradient

Water Table Contours

Modelled Extent of Contaminants

Geo-Technical Cross Sections

UST Detail and Removal

Soil Management Plans

Asbestos Abatement

45 Day LUST

Customized project? No problem! We enjoy any challenge you might have for us. Our ability to generate extremely detailed site maps from either professional surveys or aerial imagery, read and interpret laboratory analytical results and create pristine and complete figure sets using Adobe Acrobat has made us a one stop shop for all your Environmental CADD needs.

3030 Warrenville Road, Suite 418, Lisle, IL 60532

Phone: (888) 405-1742

Email: Info@A3E.com

<https://A3E.com>